

High Efficiency Helium Leak Check

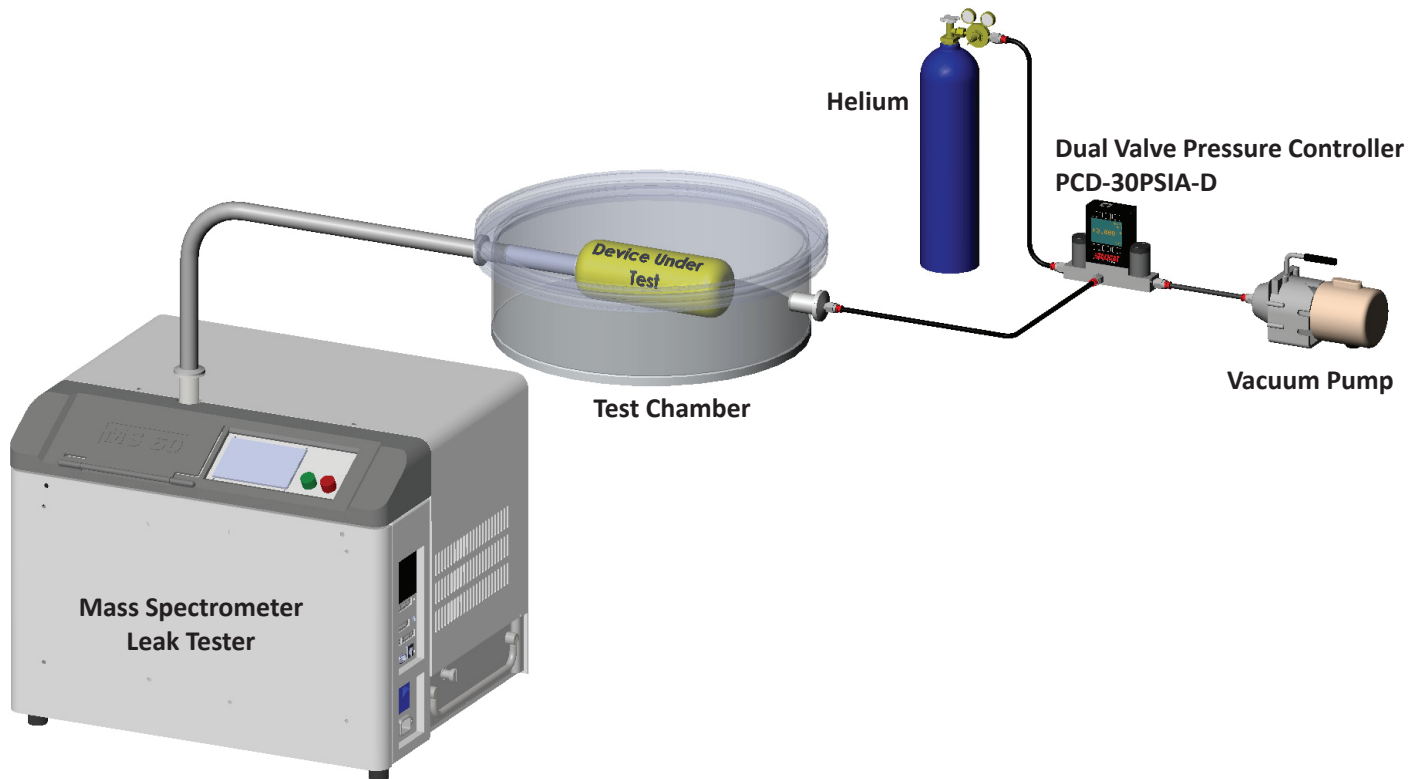

High Efficiency Helium Leak Check:

The interior of a test article is connected to a mass spectrometer leak test apparatus.

This is placed in a chamber.

The chamber is evacuated through a connection to an **Alicat PCD-30PSIA-D Dual Valve Absolute Pressure Controller**.

The chamber is then refilled to slightly above atmospheric pressure, with helium.

This provides a pure helium environment for testing leakage flow from the outside of the test article to its interior.

The interior of the test article is evacuated by the leak test apparatus.

Advantages:

A stable, reproducible helium atmosphere is created around the test article.

Helium usage is reduced as compared to continuous flow systems.